



## Product Information Notification (PIN)

### PN 25320-X and PN 25323-X Bonnet Material

REV	DATE	DESCRIPTION	ORIGIN (issued by)	APPROVED
<b>Rev 002</b>	<b>03-13-2024</b>	<b>Updated format</b>	<b>BR</b>	<b>DJ</b>
<b>Rev 001</b>	<b>01-08-2019</b>	<b>Document No: 110-010819-001</b>	<b>BR</b>	<b>SS</b>

#### COMPANY PROPRIETARY INFORMATION

Gilmore Technologies, LLC and/or its affiliates (Gilmore). All rights reserved. Gilmore™, Gilmore & Design (Stallion) are registered trademarks or trademarks of Gilmore. This notice and the information contained herein is not to be, in whole or in part, reproduced or transmitted in any form by any means without the express permission of Gilmore. **DISCLAIMER:** Whilst Gilmore has carefully reviewed the contents of this notice and believes the information to be correct, Gilmore does not assume any liability in connection with any use of or reliance upon this information and gives no representation or warranty, express or implied, in respect of the information or any products described herein. This notice is intended for use by persons having suitable technical expertise and skill, at their own discretion and risk. Gilmore may change the information contained herein at any time without notice.

---

#### For more information:

Call (800) 469-8786

[info@gilmore.com](mailto:info@gilmore.com)

Gilmore  
1231 Lumpkin Road  
Houston, TX 77043

**PN 25320-X and PN 25323-X Bonnet Material**

Gilmore announces a bonnet change to our Hydraulic Relief Valve series: PN 25320-X and PN 25323-X. For the relief valve part numbers listed below, the CF8M bonnet casting will be temporarily changed to 316 SS machined bonnet until new castings can be restocked.

Please note that while this change increases the valve envelope, it does not affect the valve's port location. The bonnet maximum width has now increased from 2.00 inches to 2.70 inches. The porting location for these bonnets are identical and can be swapped out directly.

The following part numbers are immediately affected by this change:

PN 25320-1, PN 25320-2, PN 25320-3, PN 25320-4, PN 25320-5  
PN 25323-1, PN 25323-2, PN 25323-3, PN 25323-4, PN 25323-5

Figure 1. PN 25320-1 with obsolete cast bonnet PN 23401-2 (Left) and new machined bonnet PN 23401-3 (Right)



**PN 25320-X and PN 25323-X Bonnet Material**

Figure 2. PN 25320-1 with cast bonnet PN 23401-2: Reference Dimensions

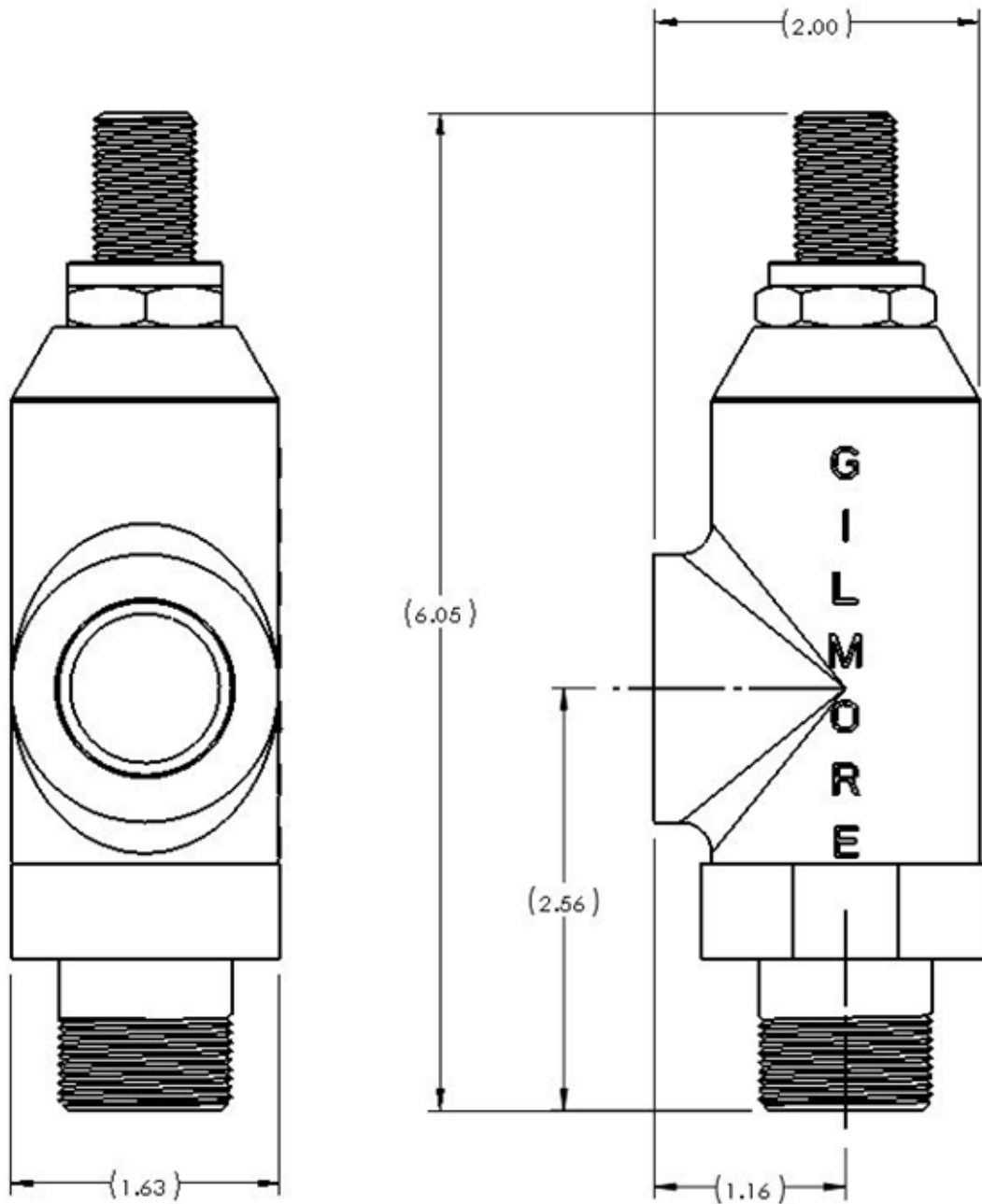

PN 25320-X and PN 25323-X Bonnet Material

Figure 3. PN 25320-1 with machined bonnet PN 23401-3: Reference Dimensions

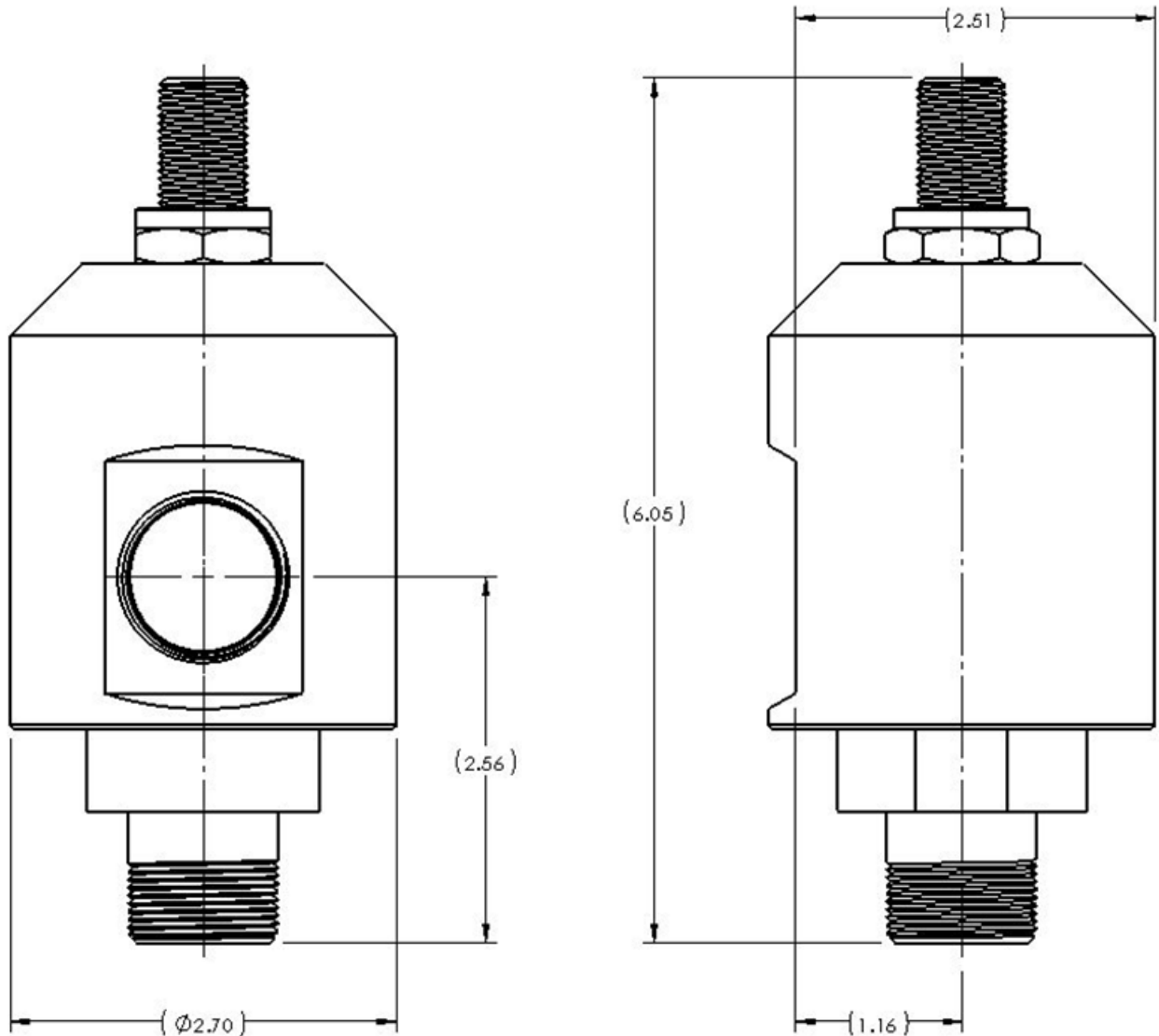

Please contact Gilmore Customer Service should you have any questions or concerns regarding this change at [INFO@Gilmore.com](mailto:INFO@Gilmore.com).