



## Product Improvement Notification (PIN)

### PN 25320-X and PN 25323-X Bonnet Material

REV	DATE	DESCRIPTION	ORIGIN (issued by)	APPROVED
REV 001	5/10/21	Document No: 110-051021-001	GM	BR

#### COMPANY PROPRIETARY INFORMATION

© Proserv Gilmore Valve, LLC and/or its affiliates (Gilmore). All rights reserved. Proserv®, Gilmore™, Gilmore & Design (Stallion) are registered trademarks or trademarks of Gilmore. This notice and the information contained herein is not to be, in whole or in part, reproduced or transmitted in any form by any means without the express permission of Gilmore. **DISCLAIMER:** Whilst Gilmore has carefully reviewed the contents of this notice and believes the information to be correct, Gilmore does not assume any liability in connection with any use of or reliance upon this information and gives no representation or warranty, express or implied, in respect of the information or any products described herein. This notice is intended for use by persons having suitable technical expertise and skill, at their own discretion and risk. Gilmore may change the information contained herein at any time without notice.

---

#### For more information:

Call (800) 469-8786  
info@gilmore.com

Gilmore  
1231 Lumpkin Road Houston,  
TX 77043

**PN 25320-X and PN 25323-X Bonnet Material**

Gilmore Valve announces a material improvement to our Hydraulic Relief Valve PN 25320-X and PN 25323-X series. The 316SS bar bonnet supplied since January 2019 is being discontinued and replaced with a cast bonnet once again.

The new cast bonnet, PN 23401-4 is now made from CF8M, a cast grade equivalent to 316 SS in corrosion resistance. This allows us to reduce the weight and footprint back to the original design while keeping the corrosion resistance benefits of the stainless bonnet.

Please note that while this change decreases the valve envelope, it does not affect the valve's port location. The bonnet maximum width has now decreased to 2.00 inches from 2.70 inches. The porting location for these bonnets continues to be identical and can be swapped out directly.

The following part numbers are immediately affected by this change:

PN 25320-1, PN 25320-2, PN 25320-3, PN 25320-4, PN 25320-5

PN 25323-1, PN 25323-2, PN 25323-3, PN 25323-4, PN 25323-5



Figure 1. 25320-2 with Bar Bonnet left, replaced with CF8M Cast bonnet on the right. Port locations remain identical

PN 25320-X and PN 25323-X Bonnet Material

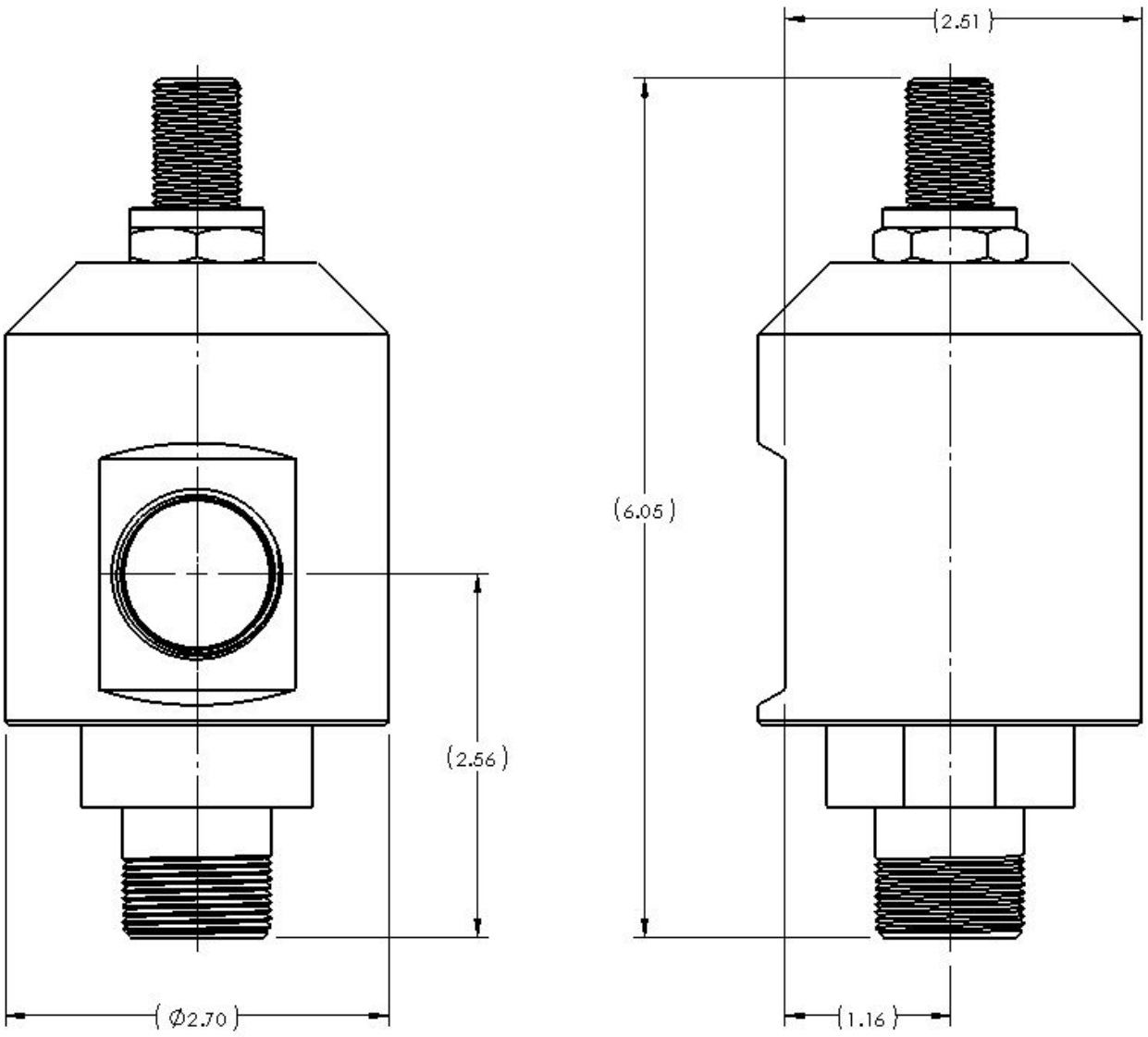

Figure 2. PN 25320-1 with 316SS Bar Bonnet

PN 25320-X and PN 25323-X Bonnet Material

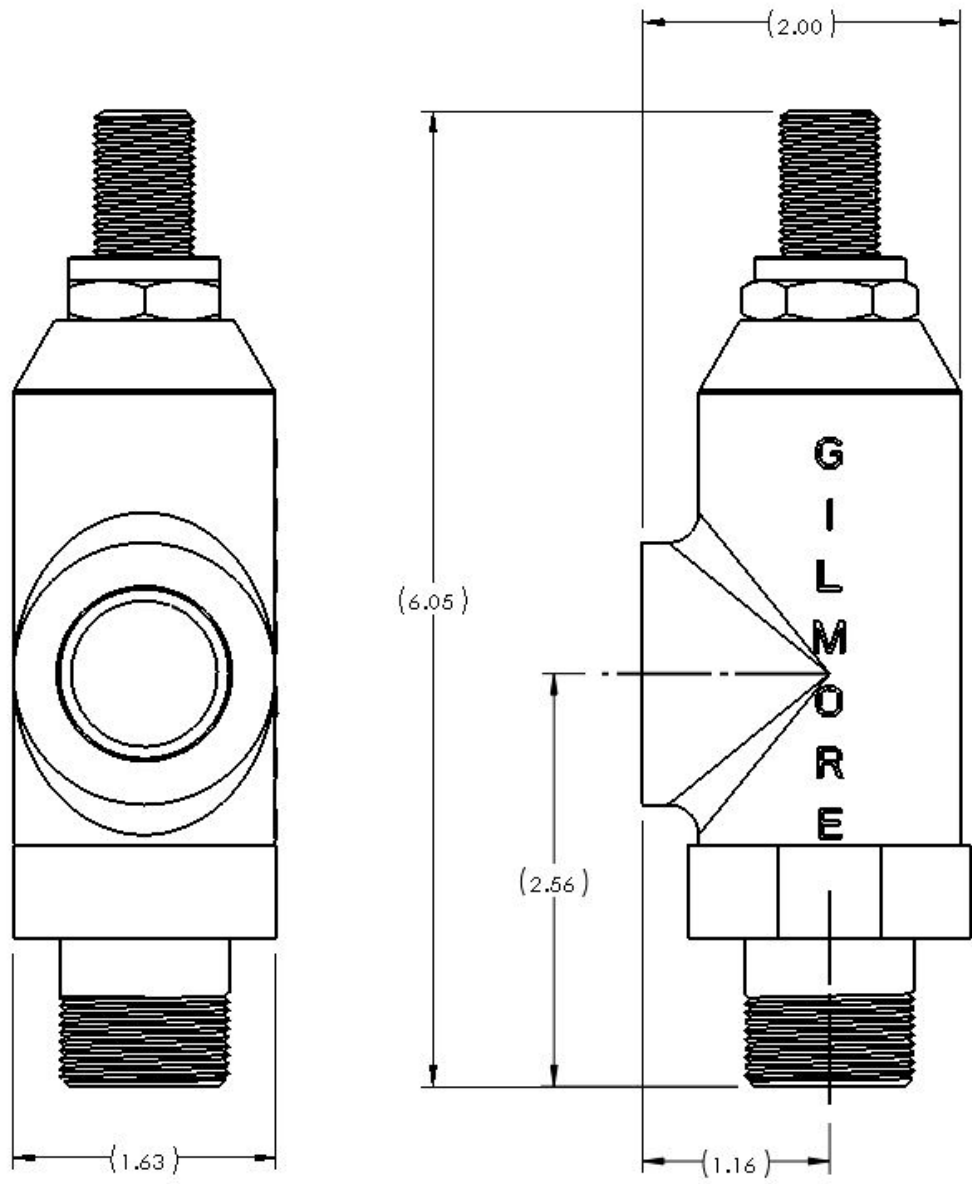

Figure 3. PN 25320-1 with CF8M Cast bonnet: Reference Dimensions

Please contact Gilmore Customer Service to request any drawings, manuals, and quotations for these relief valves at [info@gilmore.com](mailto:info@gilmore.com).